

## Meeting Space Floor Plans

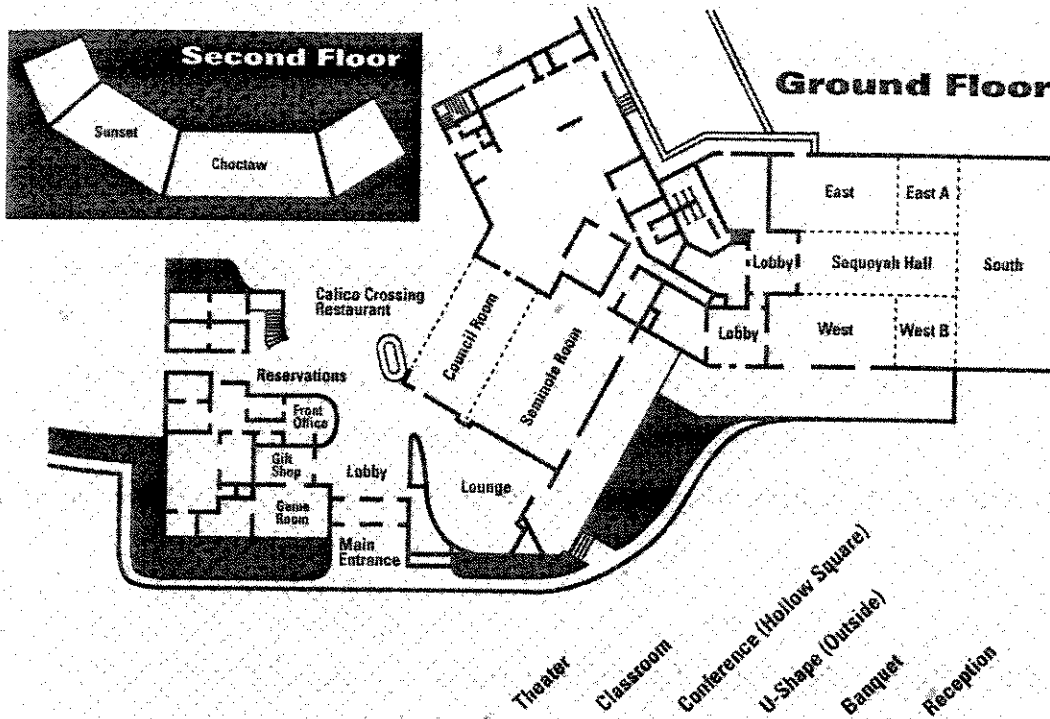

Room Dimensions						
Sunset 15' x 31' / 465 sq. ft.	50	30	20	18	N/A	62
Choctaw 18' x 48' / 864 sq. ft.	100	54	38	34	70	115
Seminole 32' x 55' / 1,760 sq. ft.	150	110	77	68	90	235
Sequoyah 68' x 99' / 6,732 sq. ft.	775	420	N/A	N/A	575	898
South 63' x 40' / 2,520 sq. ft.	290	155	155	135	200	340
East 38' x 24' / 912 sq. ft.	100	55	55	45	75	125
East A 20' x 24' / 480 sq. ft.	50	30	25	25	25	75
West 38' x 24' / 912 sq. ft.	100	55	55	45	75	125
West B 20' x 24' / 480 sq. ft.	50	30	25	25	25	75
OK Corral	45	30	25	25	25	60
Council 24' x 33' / 792 sq. ft.	30	25	16	30	30	40

### Audio-visual equipment available at no charge:

- Overhead
- 35mm slide projector
- Portable stages
- Lecturns
- Chalkboards & easels
- Portable & floor microphones
- TV & VCR
- Projection screens
- Podiums
- Padded metal stack chairs